

PHANTOM Battery Unit

Recessed cabinet,
Emergency Lighting System



Features

- **Fully automatic operation:** the unit door opens upon loss of AC power and closes when the power is back or at the end of battery discharge
- **Input:** Standard AC input 120/347Vac, 0.25/0.09 Amps; optional 120/277Vac
- **Battery:** maintenance-free, sealed Lead-acid battery, with a 10-year design life
- **Charger:** micro-controller driven, temperature compensated, high-precision, fast recharge
- **Back-box (self-powered unit):** made of heavy-duty, galvanized steel
- **Remote fixture:** version available in 12Vdc or 24Vdc; no back box, no AC wires are required
- **Certification:** CSA C22.2 No.141



Made in Canada



Typical Specification

Supply and install Lumacell Series Phantom. The unit shall be designed to be concealed in walls or ceilings with a cavity, including T-bar suspended ceilings. Bar hanger brackets shall be provided with the self-powered unit. The equipment shall consist of a metal back box containing the batteries, the lamp assembly and a charging circuitry. The back box shall be constructed of heavy-duty galvanized steel. The unit components: battery assembly, charger circuitry and lamp assembly shall have a modular design and come standard with quick connect plugs for easy installation in the back box. The unit equipment shall be completely concealed in the wall or ceiling during normal power conditions. Upon a power failure the unit will expose the emergency heads by rotating its door 180° and then power the lamps. At the restoration of the AC power or at the end of the battery discharge, the lamps will turn off and the unit will retract the heads in the wall (ceiling) by rotating the door by 180°. Under normal conditions, the only visible parts of the unit shall be the flat door and trim plate, coated with a high-quality off-white finish that can be customized on site with paint or other suitable wall covering. The light source shall be 12V MR16 halogen lamps of specified wattage and light output. The unit shall supply the rated load for a minimum of 30 minutes or until the battery is discharged to 87 ½% of its nominal

voltage (whichever duration is longer). The charger circuitry shall utilize a micro-controller IC that samples the battery in relation to the ambient temperature, state of charge, and input voltage fluctuations. The charger shall be current limited, temperature compensated, short-circuit proof, and reverse-polarity protected. The circuit will charge in accordance with the CSA C22.2 – 141 requirements. The unit shall be furnished with a recessed, illuminated push button serving as test switch and status indicator light.

Auto-test and diagnostic: the unit will come complete with the Lumacell™ series of auto-test micro-controller circuitry that will ensure the equipment readiness and reliability by continuously monitoring every critical function of the unit. If a problem occurs, the pilot light located on the front of the unit, will change color from green to red and will flash indicating a fault. A detailed diagnostic legend shall be available on the door back side and shall provide fault identification (battery, charger circuitry, lamps) for the maintenance personnel. The auto-test shall simulate a power loss for one minute monthly, 10 minutes every sixth months, and a full 30-minute test every 12 months.

The equipment shall be Lumacell model: _____.

In the same family...



PHANTOM

Remote Fixtures p. 172 - 173

Project/Location		Date
Contractor		Prepared by
LUMACELL Model		



Opened



Closed

PHANTOM SERIES

Dimensions

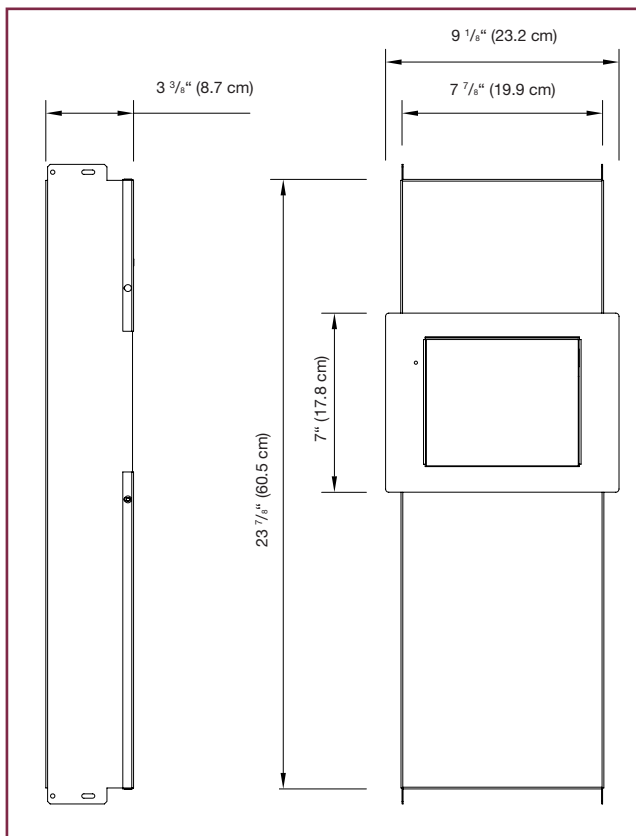

Power Consumption and Unit Rating

Model	AC Specs		Wattage Capacity				
			30min	1h00	1h30	2h00	4h00
PH75	120/347 Vac	0.25/0.09 Amp	75	40	30	24	15
PH150			150	80	60	48	30

Replacement Lamps

Model	Lamp Type	Voltage-Wattage
580.0080-L	MR16 12W Flood	12V-12W
580.0064-L	MR16 20W Flood	12V-20W
580.0083-L	MR16 35W Flood	12V-35W
580.0076-L	MR16 50W Flood	12V-50W
580.0068-L	MR16 IR* 20W Flood	12V-20W
580.0090-L	MR16 IR* 35W Flood	12V-35W
580.0089-L	MR16 IR* 50W Flood	12V-50W
580.0084-L	MR16	24V-35W
580.0070-L	MR16	24V-12W
580.0077-L	MR16	24V-20W
580.0078-L	MR16	24V-50W

* High-output (H).

See the complete list p. 196 to 199.

Ordering Information

Series	Unit Capacity	Lamp Wattage	AC Voltage	Options
PH	75 = 12V, 75W	12W = 2x 12 watts MR16	Blank = 120/347Vac ZC = 120/277Vac	AT = Auto-Test ATN = Auto-Test, non-audible T3 = Time delay (15 minutes)
	150 = 12V, 150W	20W = 2x 20 watts MR16		
		35W = 2x 35 watts MR16		
		50W = 2x 50 watts MR16		
		20WH = 2x 20 watts MR16, High lumen-output lamp		
		35WH = 2x 35 watts MR16, High lumen-output lamp		
	50WH = 2x 50 watts MR16, High lumen-output lamp			

EXAMPLE: PH15012WAT